

TIMING BELT PULLEYS

5MM HTD PITCH

ALUMINUM WITH CLEAR ANODIZE (RoHS compliant)

FOR BELTS UP TO 9MM WIDE

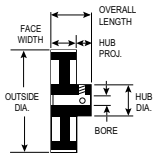

TYPE 6W

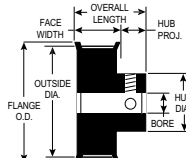

TYPE 6F

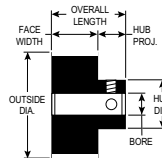

TYPE 6



PART NUMBER	NO. OF GROOVES	PITCH DIA.	OUTSIDE DIA.	FLANGE O.D.	TYPE	BORE	FACE WIDTH	OVERALL LENGTH	HUB DIA.	SET SCREWS (2@90°)
14-5M-09 X 1/4	14	.877	.832	1.000	6F	.2500	.547	.790	.500	8-32
15-5M-09 X 1/4	15	.940	.895	1.063	6F	.2500	.547	.790	.563	8-32
16-5M-09 X 1/4	16	1.003	.958	1.094	6F	.2500	.547	.790	.563	8-32
17-5M-09 X 1/4	17	1.065	1.020	1.187	6F	.2500	.547	.790	.625	8-32
18-5M-09 X 1/4	18	1.128	1.083	1.250	6F	.2500	.547	.790	.688	8-32
19-5M-09 X 1/4	19	1.191	1.146	1.313	6F	.2500	.547	.790	.750	8-32
20-5M-09 X 1/4	20	1.253	1.208	1.375	6F	.2500	.547	.790	.813	8-32
22-5M-09 X 1/4	22	1.379	1.334	1.500	6F	.2500	.547	.790	.938	8-32
24-5M-09 X 1/4	24	1.504	1.459	1.625	6F	.2500	.547	.852	1.000	8-32
26-5M-09 X 1/4	26	1.629	1.584	1.750	6F	.2500	.547	.852	1.063	8-32
28-5M-09 X 1/4	28	1.754	1.709	1.875	6F	.2500	.547	.852	1.188	8-32
30-5M-09 X 1/4	30	1.880	1.835	2.000	6F	.2500	.547	.852	1.188	8-32
32-5M-09 X 1/4	32	2.005	1.960	2.125	6F	.2500	.547	.852	1.250	8-32
34-5M-09 X 1/4	34	2.130	2.085	2.250	6F	.2500	.547	.852	1.375	8-32
36-5M-09 X 5/16	36	2.256	2.211	-	6	.3125	.547	.938	1.500	8-32
38-5M-09 X 5/16	38	2.381	2.336	-	6	.3125	.547	.938	1.500	8-32
40-5M-09 X 5/16	40	2.506	2.461	-	6	.3125	.547	.938	1.500	8-32
44-5M-09 X 5/16	44	2.757	2.712	-	6W	.3125	.547	.938	1.500	8-32
50-5M-09 X 3/8	50	3.133	3.088	-	6W	.3750	.547	.938	1.500	10-32
56-3M-09 X 3/8	56	3.509	3.464	-	6W	.3750	.547	.938	1.500	10-32
62-5M-09 X 3/8	62	3.885	3.840	-	6W	.3750	.547	.938	1.500	10-32
72-5M-09 X 3/8	72	4.511	4.466	-	6W	.3750	.547	.938	1.500	10-32



ALUMINUM WITH CLEAR ANODIZE (RoHS compliant)

FOR BELTS UP TO 15MM WIDE

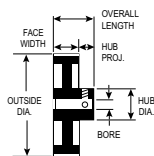

TYPE 6W

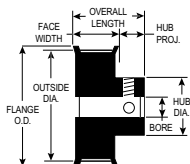

TYPE 6F

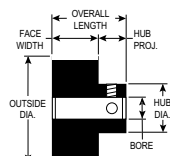

TYPE 6

PART NUMBER	NO. OF GROOVES	PITCH DIA.	OUTSIDE DIA.	FLANGE O.D.	TYPE	BORE	FACE WIDTH	OVERALL LENGTH	HUB DIA.	SET SCREWS (2@90°)
14-5M-15 X 1/4	14	.877	.832	1.000	6F	.2500	.781	1.025	.500	8-32
15-5M-15 X 1/4	15	.940	.895	1.063	6F	.2500	.781	1.025	.563	8-32
16-5M-15 X 1/4	16	1.003	.958	1.094	6F	.2500	.781	1.025	.563	8-32
17-5M-15 X 1/4	17	1.065	1.020	1.187	6F	.2500	.781	1.025	.625	8-32
18-5M-15 X 1/4	18	1.128	1.083	1.250	6F	.2500	.781	1.025	.688	8-32
19-5M-15 X 1/4	19	1.191	1.146	1.313	6F	.2500	.781	1.025	.750	8-32
20-5M-15 X 1/4	20	1.253	1.208	1.375	6F	.2500	.781	1.025	.813	8-32
22-5M-15 X 1/4	22	1.379	1.334	1.500	6F	.2500	.781	1.025	.938	8-32
24-5M-15 X 1/4	24	1.504	1.459	1.625	6F	.2500	.781	1.087	1.000	8-32
26-5M-15 X 1/4	26	1.629	1.584	1.750	6F	.2500	.781	1.087	1.063	8-32
28-5M-15 X 1/4	28	1.754	1.709	1.875	6F	.2500	.781	1.087	1.188	8-32
30-5M-15 X 1/4	30	1.880	1.835	2.000	6F	.2500	.781	1.087	1.188	8-32
32-5M-15 X 1/4	32	2.005	1.960	2.125	6F	.2500	.781	1.087	1.250	8-32
34-5M-15 X 1/4	34	2.130	2.085	2.250	6F	.2500	.781	1.087	1.375	8-32
36-5M-15 X 5/16	36	2.256	2.211	-	6	.3125	.781	1.094	1.500	8-32
38-5M-15 X 5/16	38	2.381	2.336	-	6	.3125	.781	1.094	1.500	8-32
40-5M-15 X 5/16	40	2.506	2.461	-	6	.3125	.781	1.094	1.500	8-32
44-5M-15 X 5/16	44	2.757	2.712	-	6W	.3125	.781	1.094	1.500	8-32
50-5M-15 X 3/8	50	3.133	3.088	-	6W	.3750	.781	1.188	1.500	10-32
56-5M-15 X 3/8	56	3.509	3.464	-	6W	.3750	.781	1.188	1.500	10-32
62-5M-15 X 3/8	62	3.885	3.840	-	6W	.3750	.781	1.188	1.500	10-32
72-5M-15 X 3/8	72	4.511	4.466	-	6W	.3750	.781	1.188	1.500	10-32

ALUMINUM 6061-T6 (RoHS compliant)

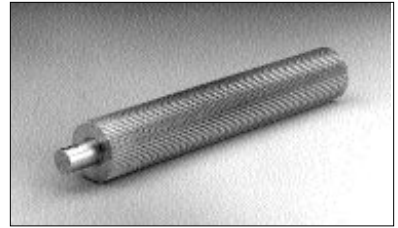
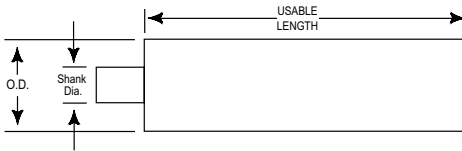

PART NUMBER	NO. OF GROOVES	PITCH DIA.	OUTSIDE DIA.	SHANK DIA.	USEABLE LENGTH
12-5M-P-6A	12	.753	.708	1/2	6"
13-5M-P-6A	13	.815	.770	1/2	6"
14-5M-P-7A	14	.877	.832	1/2	7"
15-5M-P-7A	15	.940	.895	1/2	7"
16-5M-P-7A	16	1.003	.958	1/2	7"
17-5M-P-7A	17	1.065	1.020	1/2	7"
18-5M-P-8A	18	1.128	1.083	1/2	8"
19-5M-P-8A	19	1.191	1.146	1/2	8"
20-5M-P-8A	20	1.253	1.208	1/2	8"
21-5M-P-8A	21	1.316	1.271	1/2	8"
22-5M-P-8A	22	1.379	1.334	1/2	8"
23-5M-P-8A	23	1.441	1.396	1/2	8"
24-5M-P-8A	24	1.504	1.459	1/2	8"
25-5M-P-8A	25	1.566	1.521	1/2	8"
26-5M-P-8A	26	1.629	1.584	1/2	8"
27-5M-P-8A	27	1.692	1.647	1/2	8"
28-5M-P-8A	28	1.754	1.709	1/2	8"
29-5M-P-8A	29	1.817	1.772	1/2	8"
30-5M-P-8A	30	1.880	1.835	1/2	8"
31-5M-P-8A	31	1.942	1.897	3/4	8"
32-5M-P-8A	32	2.005	1.960	3/4	8"

ALUMINUM 6061-T6 (RoHS compliant)

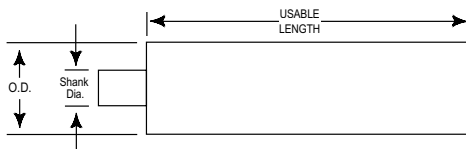
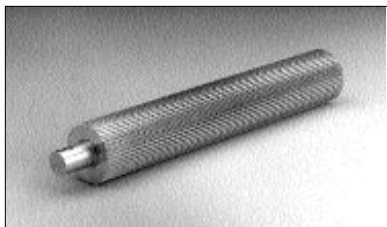

PART NUMBER	NO. OF GROOVES	PITCH DIA.	OUTSIDE DIA.	SHANK DIA.	USEABLE LENGTH
33-5M-P-8A	33	2.068	2.023	3/4	8"
34-5M-P-8A	34	2.130	2.085	3/4	8"
35-5M-P-8A	35	2.193	2.148	3/4	8"
36-5M-P-8A	36	2.256	2.211	3/4	8"
38-5M-P-8A	38	2.381	2.336	3/4	8"
40-5M-P-8A	40	2.506	2.461	3/4	8"
42-5M-P-8A	42	2.632	2.587	3/4	8"
44-5M-P-8A	44	2.757	2.712	3/4	8"
45-5M-P-8A	45	2.820	2.775	3/4	8"
46-5M-P-8A	46	2.882	2.837	3/4	8"
48-5M-P-8A	48	3.008	2.963	3/4	8"
50-5M-P-8A	50	3.133	3.088	3/4	8"
54-5M-P-8A	54	3.384	3.339	3/4	8"
60-5M-P-8A	60	3.760	3.715	3/4	8"
62-5M-P-8A	62	3.885	3.840	3/4	8"
72-5M-P-8A	72	4.511	4.466	1	8"
80-5M-P-8A	80	5.013	4.968	1	8"
90-5M-P-8A	90	5.639	5.594	1	8"
100-5M-P-6A	100	6.266	6.221	1	6"
112-5M-P-6A	112	7.018	6.973	1	6"
126-5M-P-6A	126	7.895	7.850	1	6"

STEEL (RoHS compliant)

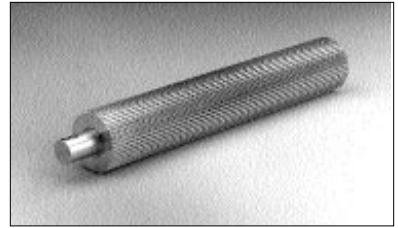
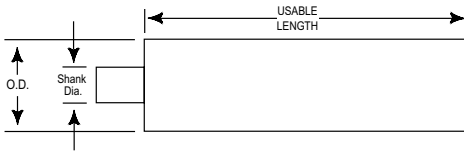

PART NUMBER	NO. OF GROOVES	PITCH DIA.	OUTSIDE DIA.	SHANK DIA.	USEABLE LENGTH
12-5M-P-6S	12	.753	.708	1/2	6"
13-5M-P-6S	13	.815	.770	1/2	6"
14-5M-P-7S	14	.877	.832	1/2	7"
15-5M-P-7S	15	.940	.895	1/2	7"
16-5M-P-7S	16	1.003	.958	1/2	7"
17-5M-P-7S	17	1.065	1.020	1/2	7"
18-5M-P-8S	18	1.128	1.083	1/2	8"
19-5M-P-8S	19	1.191	1.146	1/2	8"
20-5M-P-8S	20	1.253	1.208	1/2	8"
21-5M-P-8S	21	1.316	1.271	1/2	8"
22-5M-P-8S	22	1.379	1.334	1/2	8"
23-5M-P-8S	23	1.441	1.396	1/2	8"
24-5M-P-8S	24	1.504	1.459	1/2	8"
25-5M-P-8S	25	1.566	1.521	1/2	8"
26-5M-P-8S	26	1.629	1.584	1/2	8"
27-5M-P-8S	27	1.692	1.647	1/2	8"
28-5M-P-8S	28	1.754	1.709	1/2	8"
29-5M-P-8S	29	1.817	1.772	1/2	8"
30-5M-P-8S	30	1.880	1.835	1/2	8"



STEEL (RoHS compliant)

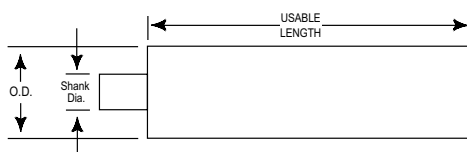
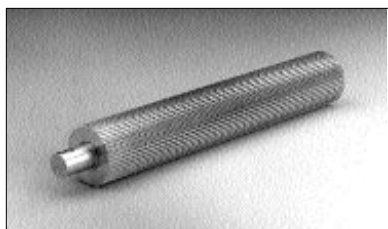

PART NUMBER	NO. OF GROOVES	PITCH DIA.	OUTSIDE DIA.	SHANK DIA.	USEABLE LENGTH
31-5M-P-8S	31	1.942	1.897	3/4	8"
32-5M-P-8S	32	2.005	1.960	3/4	8"
33-5M-P-8S	33	2.068	2.023	3/4	8"
34-5M-P-8S	34	2.130	2.085	3/4	8"
35-5M-P-8S	35	2.193	2.148	3/4	8"
36-5M-P-8S	36	2.256	2.211	3/4	8"
38-5M-P-8S	38	2.381	2.336	3/4	8"
40-5M-P-8S	40	2.506	2.461	3/4	8"
42-5M-P-8S	42	2.632	2.587	3/4	8"
44-5M-P-8S	44	2.757	2.712	3/4	8"
45-5M-P-8S	45	2.820	2.775	3/4	8"
48-5M-P-8S	48	3.008	2.963	3/4	8"
50-5M-P-8S	50	3.133	3.088	3/4	8"
60-5M-P-8S	60	3.760	3.715	3/4	8"
72-5M-P-8S	72	4.511	4.466	1	8"
80-5M-P-8S	80	5.013	4.968	1	8"
90-5M-P-8S	90	5.639	5.594	1	8"

ALUMINUM (RoHS compliant)

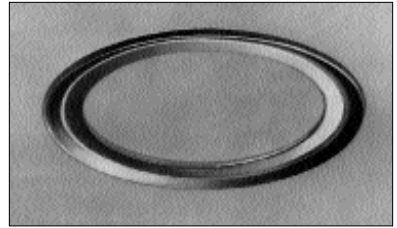
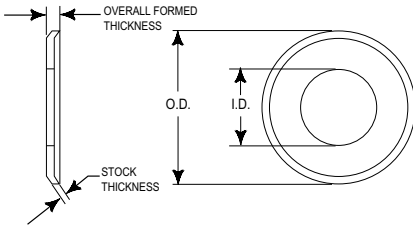

PART NUMBER	INSIDE DIA.	OUTSIDE DIA.	STOCK THICKNESS	OVERALL FORMED THICKNESS
12-5M-F7A	.503	.875	.040	.065
13-5M-F7A	.562	.937	.040	.065
14-5M-F7A	.562	1.000	.040	.065
15-5M-F7A	.625	1.062	.040	.065
16-5M-F7A	.684	1.093	.040	.065
17-5M-F7A	.748	1.187	.040	.065
18-5M-F7A	.810	1.250	.040	.065
19-5M-F7A	.887	1.312	.040	.065
20-5M-F7A	.936	1.375	.040	.065
21-5M-F7A	1.000	1.437	.040	.065
22-5M-F7A	1.062	1.500	.040	.065
23-5M-F7A	1.125	1.562	.040	.065
24-5M-F7A	1.160	1.625	.040	.065
25-5M-F7A	1.223	1.687	.040	.065
26-5M-F7A	1.222	1.750	.040	.065
28-5M-F7A	1.347	1.875	.040	.065
30-5M-F7A	1.425	2.000	.040	.065
32-5M-F7A	1.550	2.125	.040	.065
34-5M-F7A	1.675	2.250	.040	.065

STEEL (RoHS compliant)

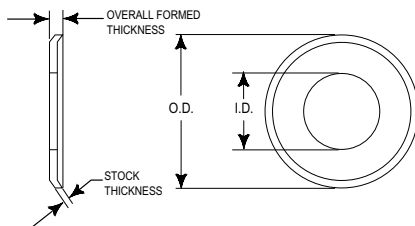
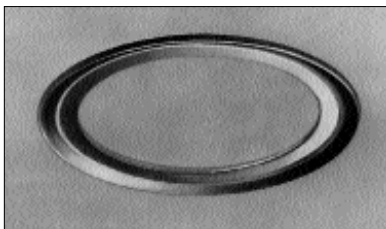

PART NUMBER	INSIDE DIA.	OUTSIDE DIA.	STOCK THICKNESS	OVERALL FORMED THICKNESS
12-5M-F8S	.503	.875	.040	.065
13-5M-F8S	.562	.937	.040	.065
14-5M-F8S	.562	1.000	.040	.065
15-5M-F8S	.625	1.062	.040	.065
16-5M-F8S	.684	1.093	.040	.065
17-5M-F8S	.748	1.187	.040	.065
18-5M-F8S	.810	1.250	.040	.065
19-5M-F8S	.887	1.312	.040	.065
20-5M-F8S	.936	1.375	.040	.065
21-5M-F8S	1.000	1.437	.040	.065
22-5M-F8S	1.062	1.500	.040	.065
23-5M-F8S	1.125	1.562	.040	.065
24-5M-F8S	1.160	1.625	.040	.065
25-5M-F8S	1.223	1.687	.040	.065
26-5M-F8S	1.222	1.750	.040	.065
28-5M-F8S	1.347	1.875	.040	.065
30-5M-F8S	1.425	2.000	.040	.065
32-5M-F8S	1.550	2.125	.040	.065
34-5M-F8S	1.675	2.250	.040	.065

BLACK NEOPRENE, FIBERGLASS CORD (RoHS compliant)

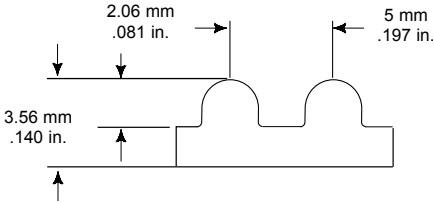

BELT NUMBER	WIDTHS			PITCH LENGTH (MM)	NO. OF TEETH	BELT NUMBER	WIDTHS			PITCH LENGTH (MM)	NO. OF TEETH
	9MM	15MM	25MM				9MM	15MM	25MM		
200-5M	09	15	25	200	40	490-5M	09	15	25	490	98
215-5M	09	15	25	215	43	495-5M	09	15	25	495	99
225-5M	09	15	25	225	45	500-5M	09	15	25	500	100
240-5M	09	15	25	240	48	510-5M	09	15	25	510	102
250-5M	09	15	25	250	50	520-5M	09	15	25	520	104
260-5M	09	15	25	260	52	525-5M	09	15	25	525	105
265-5M	09	15	25	265	53	530-5M	09	15	25	530	106
270-5M	09	15	25	270	54	535-5M	09	15	25	535	107
275-5M	09	15	25	275	55	540-5M	09	15	25	540	108
285-5M	09	15	25	285	57	550-5M	09	15	25	550	110
295-5M	09	15	25	295	59	555-5M	09	15	25	555	111
300-5M	09	15	25	300	60	565-5M	09	15	25	565	113
310-5M	09	15	25	310	62	575-5M	09	15	25	575	115
320-5M	09	15	25	320	64	580-5M	09	15	25	580	116
325-5M	09	15	25	325	65	585-5M	09	15	25	585	117
330-5M	09	15	25	330	66	590-5M	09	15	25	590	118
340-5M	09	15	25	340	68	600-5M	09	15	25	600	120
350-5M	09	15	25	350	70	615-5M	09	15	25	615	123
355-5M	09	15	25	355	71	625-5M	09	15	25	625	125
360-5M	09	15	25	360	72	635-5M	09	15	25	635	127
375-5M	09	15	25	375	75	650-5M	09	15	25	650	130
400-5M	09	15	25	400	80	655-5M	09	15	25	655	131
405-5M	09	15	25	405	81	665-5M	09	15	25	665	133
410-5M	09	15	25	410	82	670-5M	09	15	25	670	134
415-5M	09	15	25	415	83	680-5M	09	15	25	680	136
425-5M	09	15	25	425	85	685-5M	09	15	25	685	137
450-5M	09	15	25	450	90	695-5M	09	15	25	695	139
460-5M	09	15	25	460	92	700-5M	09	15	25	700	140
475-5M	09	15	25	475	95	710-5M	09	15	25	710	142
480-5M	09	15	25	480	96	740-5M	09	15	25	740	148



BLACK NEOPRENE, FIBERGLASS CORD (RoHS compliant)

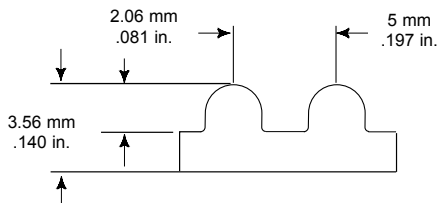

BELT NUMBER	WIDTHS			PITCH LENGTH (MM)	NO. OF TEETH	BELT NUMBER	WIDTHS			PITCH LENGTH (MM)	NO. OF TEETH
	9MM	15MM	25MM				9MM	15MM	25MM		
745-5M	09	15	25	745	149	1420-5M	09	15	25	1420	284
750-5M	09	15	25	750	150	1450-5M	09	15	25	1450	290
765-5M	09	15	25	765	153	1500-5M	09	15	25	1500	300
775-5M	09	15	25	775	155	1575-5M	09	15	25	1575	315
790-5M	09	15	25	790	158	1595-5M	09	15	25	1595	319
800-5M	09	15	25	800	160	1600-5M	09	15	25	1600	320
815-5M	09	15	25	815	163	1635-5M	09	15	25	1635	327
830-5M	09	15	25	830	166	1690-5M	09	15	25	1690	338
835-5M	09	15	25	835	167	1720-5M	09	15	25	1720	344
850-5M	09	15	25	850	170	1755-5M	09	15	25	1755	351
860-5M	09	15	25	860	172	1790-5M	09	15	25	1790	358
870-5M	09	15	25	870	174	1800-5M	09	15	25	1800	360
890-5M	09	15	25	890	178	1850-5M	09	15	25	1850	370
900-5M	09	15	25	900	180	1895-5M	09	15	25	1895	379
925-5M	09	15	25	925	185	1945-5M	09	15	25	1945	389
950-5M	09	15	25	950	190	1980-5M	09	15	25	1980	396
975-5M	09	15	25	975	195	2000-5M	09	15	25	2000	400
980-5M	09	15	25	980	196	2100-5M	09	15	25	2100	420
985-5M	09	15	25	985	197	2110-5M	09	15	25	2110	422
1000-5M	09	15	25	1000	200	2250-5M	09	15	25	2250	450
1050-5M	09	15	25	1050	210	2440-5M	09	15	25	2440	488
1115-5M	09	15	25	1115	223	2525-5M	09	15	25	2525	505
1125-5M	09	15	25	1125	225	2760-5M	09	15	25	2760	552
1150-5M	09	15	25	1150	230	3120-5M	09	15	25	3120	624
1195-5M	09	15	25	1195	239	3170-5M	09	15	25	3170	634
1250-5M	09	15	25	1250	250	3430-5M	09	15	25	3430	686
1270-5M	09	15	25	1270	254	3800-5M	09	15	25	3800	760
1295-5M	09	15	25	1295	259						
1300-5M	09	15	25	1300	260						
1375-5M	09	15	25	1375	275						

TRUMOTION, EPDM, FIBERGLASS CORD (RoHS compliant)

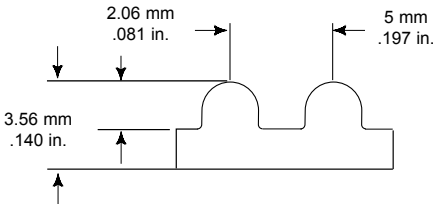

BELT NUMBER	WIDTHS			PITCH LENGTH (MM)	NO. OF TEETH	BELT NUMBER	WIDTHS			PITCH LENGTH (MM)	NO. OF TEETH
	9MM	15MM	25MM				9MM	15MM	25MM		
TM-300-5M	09	15	25	300	60	TM-700-5M	09	15	25	700	140
TM-355-5M	09	15	25	355	71	TM-750-5M	09	15	25	750	150
TM-375-5M	09	15	25	375	75	TM-800-5M	09	15	25	800	160
TM-400-5M	09	15	25	400	80	TM-815-5M	09	15	25	815	163
TM-405-5M	09	15	25	405	81	TM-850-5M	09	15	25	850	170
TM-425-5M	09	15	25	425	85	TM-900-5M	09	15	25	900	180
TM-450-5M	09	15	25	450	90	TM-1000-5M	09	15	25	1000	200
TM-500-5M	09	15	25	500	100	TM-1150-5M	09	15	25	1150	230
TM-535-5M	09	15	25	535	107	TM-1300-5M	09	15	25	1300	260
TM-565-5M	09	15	25	565	113	TM-1450-5M	09	15	25	1450	290
TM-575-5M	09	15	25	575	115	TM-1600-5M	09	15	25	1600	320
TM-580-5M	09	15	25	580	116	TM-1720-5M	09	15	25	1720	344
TM-600-5M	09	15	25	600	120	TM-1755-5M	09	15	25	1755	351
TM-625-5M	09	15	25	625	125	TM-2000-5M	09	15	25	2000	400
TM-650-5M	09	15	25	650	130	TM-2250-5M	09	15	25	2250	450



