

ALUMINUM WITH CLEAR ANODIZE (RoHS compliant)

FOR BELTS UP TO 9MM WIDE

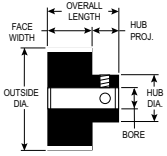

TYPE 6

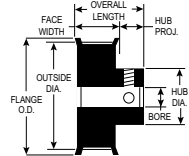

TYPE 6F



PART NUMBER	NO. OF GROOVES	PITCH DIA.	OUTSIDE DIA.	FLANGE O.D.	TYPE	BORE	FACE WIDTH	OVERALL LENGTH	HUB DIA.	SET SCREWS (2@90°)
14-5M-09 X 1/4	14	.877	.832	1.000	6F	.2500	.547	.790	.500	8-32
SAV-14-5M-09 X 1/4	14	.877	.832	1.000	6F	.2500	.547	.790	.500	8-32
15-5M-09 X 1/4	15	.940	.895	1.063	6F	.2500	.547	.790	.563	8-32
SAV-15-5M-09 X 1/4	15	.940	.895	1.063	6F	.2500	.547	.790	.563	8-32
16-5M-09 X 1/4	16	1.003	.958	1.094	6F	.2500	.547	.790	.563	8-32
SAV-16-5M-09 X 1/4	16	1.003	.958	1.094	6F	.2500	.547	.790	.563	8-32
17-5M-09 X 1/4	17	1.065	1.020	1.187	6F	.2500	.547	.790	.625	8-32
SAV-17-5M-09 X 1/4	17	1.065	1.020	1.187	6F	.2500	.547	.790	.625	8-32
18-5M-09 X 1/4	18	1.128	1.083	1.250	6F	.2500	.547	.790	.688	8-32
SAV-18-5M-09 X 1/4	18	1.128	1.083	1.250	6F	.2500	.547	.790	.688	8-32
19-5M-09 X 1/4	19	1.191	1.146	1.313	6F	.2500	.547	.790	.750	8-32
SAV-19-5M-09 X 1/4	19	1.191	1.146	1.313	6F	.2500	.547	.790	.750	8-32
20-5M-09 X 1/4	20	1.253	1.208	1.375	6F	.2500	.547	.790	.813	8-32
SAV-20-5M-09 X 1/4	20	1.253	1.208	1.375	6F	.2500	.547	.790	.813	8-32
22-5M-09 X 1/4	22	1.379	1.334	1.500	6F	.2500	.547	.790	.938	8-32
SAV-22-5M-09 X 1/4	22	1.379	1.334	1.500	6F	.2500	.547	.790	.938	8-32
24-5M-09 X 1/4	24	1.504	1.459	1.625	6F	.2500	.547	.852	1.000	8-32
SAV-24-5M-09 X 1/4	24	1.504	1.459	1.625	6F	.2500	.547	.852	1.000	8-32
26-5M-09 X 1/4	26	1.629	1.584	1.750	6F	.2500	.547	.852	1.063	8-32
SAV-26-5M-09 X 1/4	26	1.629	1.584	1.750	6F	.2500	.547	.852	1.063	8-32
28-5M-09 X 1/4	28	1.754	1.709	1.875	6F	.2500	.547	.852	1.188	8-32
SAV-28-5M-09 X 1/4	28	1.754	1.709	1.875	6F	.2500	.547	.852	1.188	8-32
30-5M-09 X 1/4	30	1.880	1.835	2.000	6F	.2500	.547	.852	1.188	8-32
SAV-30-5M-09 X 1/4	30	1.880	1.835	2.000	6F	.2500	.547	.852	1.188	8-32

“SAV-” in front of any standard timing pulley part # represents the Shaft-Saver version. Shaft-Saver pulleys have special setscrews that grip without damage to the shaft and allow easy pulley removal and realignment. For additional information, see our Shaft-Saver Engineering Section.



ALUMINUM WITH CLEAR ANODIZE (RoHS compliant)

FOR BELTS UP TO 9MM WIDE

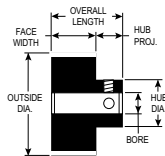

TYPE 6

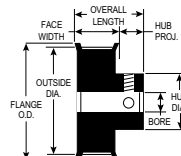

TYPE 6F

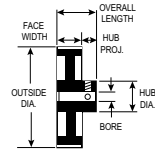

TYPE 6W

PART NUMBER	NO. OF GROOVES	PITCH DIA.	OUTSIDE DIA.	FLANGE O.D.	TYPE	BORE	FACE WIDTH	OVERALL LENGTH	HUB DIA.	SET SCREWS (2@90°)
32-5M-09 X 1/4	32	2.005	1.960	2.125	6F	.2500	.547	.852	1.250	8-32
SAV-32-5M-09 X 1/4	32	2.005	1.960	2.125	6F	.2500	.547	.852	1.250	8-32
34-5M-09 X 1/4	34	2.130	2.085	2.250	6F	.2500	.547	.852	1.375	8-32
SAV-34-5M-09 X 1/4	34	2.130	2.085	2.250	6F	.2500	.547	.852	1.375	8-32
36-5M-09 X 5/16	36	2.256	2.211	—	6	.3125	.547	.938	1.500	8-32
SAV-36-5M-09 X 5/16	36	2.256	2.211	—	6	.3125	.547	.938	1.500	8-32
38-5M-09 X 5/16	38	2.381	2.336	—	6	.3125	.547	.938	1.500	8-32
SAV-38-5M-09 X 5/16	38	2.381	2.336	—	6	.3125	.547	.938	1.500	8-32
40-5M-09 X 5/16	40	2.506	2.461	—	6	.3125	.547	.938	1.500	8-32
SAV-40-5M-09 X 5/16	40	2.506	2.461	—	6	.3125	.547	.938	1.500	8-32
44-5M-09 X 5/16	44	2.757	2.712	—	6W	.3125	.547	.938	1.500	8-32
SAV-44-5M-09 X 5/16	44	2.757	2.712	—	6W	.3125	.547	.938	1.500	8-32
50-5M-09 X 3/8	50	3.133	3.088	—	6W	.3750	.547	.938	1.500	10-32
SAV-50-5M-09 X 3/8	50	3.133	3.088	—	6W	.3750	.547	.938	1.500	10-32
56-3M-09 X 3/8	56	3.509	3.464	—	6W	.3750	.547	.938	1.500	10-32
SAV-56-3M-09 X 3/8	56	3.509	3.464	—	6W	.3750	.547	.938	1.500	10-32
62-5M-09 X 3/8	62	3.885	3.840	—	6W	.3750	.547	.938	1.500	10-32
SAV-62-5M-09 X 3/8	62	3.885	3.840	—	6W	.3750	.547	.938	1.500	10-32
72-5M-09 X 3/8	72	4.511	4.466	—	6W	.3750	.547	.938	1.500	10-32
SAV-72-5M-09 X 3/8	72	4.511	4.466	—	6W	.3750	.547	.938	1.500	10-32

“SAV-” in front of any standard timing pulley part # represents the Shaft-Saver version. Shaft-Saver pulleys have special setscrews that grip without damage to the shaft and allow easy pulley removal and realignment. For additional information, see our Shaft-Saver Engineering Section.

ALUMINUM WITH CLEAR ANODIZE (RoHS compliant)

FOR BELTS UP TO 15MM WIDE

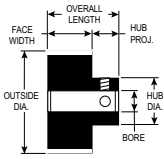

TYPE 6

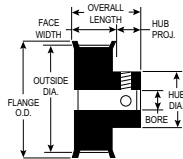

TYPE 6F



PART NUMBER	NO. OF GROOVES	PITCH DIA.	OUTSIDE DIA.	FLANGE O.D.	TYPE	BORE	FACE WIDTH	OVERALL LENGTH	HUB DIA.	SET SCREWS (2@90°)
14-5M-15 X 1/4	14	.877	.832	1.000	6F	.2500	.781	1.025	.500	8-32
SAV-14-5M-15 X 1/4	14	.877	.832	1.000	6F	.2500	.781	1.025	.500	8-32
15-5M-15 X 1/4	15	.940	.895	1.063	6F	.2500	.781	1.025	.563	8-32
SAV-15-5M-15 X 1/4	15	.940	.895	1.063	6F	.2500	.781	1.025	.563	8-32
16-5M-15 X 1/4	16	1.003	.958	1.094	6F	.2500	.781	1.025	.563	8-32
SAV-16-5M-15 X 1/4	16	1.003	.958	1.094	6F	.2500	.781	1.025	.563	8-32
17-5M-15 X 1/4	17	1.065	1.020	1.187	6F	.2500	.781	1.025	.625	8-32
SAV-17-5M-15 X 1/4	17	1.065	1.020	1.187	6F	.2500	.781	1.025	.625	8-32
18-5M-15 X 1/4	18	1.128	1.083	1.250	6F	.2500	.781	1.025	.688	8-32
SAV-18-5M-15 X 1/4	18	1.128	1.083	1.250	6F	.2500	.781	1.025	.688	8-32
19-5M-15 X 1/4	19	1.191	1.146	1.313	6F	.2500	.781	1.025	.750	8-32
SAV-19-5M-15 X 1/4	19	1.191	1.146	1.313	6F	.2500	.781	1.025	.750	8-32
20-5M-15 X 1/4	20	1.253	1.208	1.375	6F	.2500	.781	1.025	.813	8-32
SAV-20-5M-15 X 1/4	20	1.253	1.208	1.375	6F	.2500	.781	1.025	.813	8-32
22-5M-15 X 1/4	22	1.379	1.334	1.500	6F	.2500	.781	1.025	.938	8-32
SAV-22-5M-15 X 1/4	22	1.379	1.334	1.500	6F	.2500	.781	1.025	.938	8-32
24-5M-15 X 1/4	24	1.504	1.459	1.625	6F	.2500	.781	1.087	1.000	8-32
SAV-24-5M-15 X 1/4	24	1.504	1.459	1.625	6F	.2500	.781	1.087	1.000	8-32
26-5M-15 X 1/4	26	1.629	1.584	1.750	6F	.2500	.781	1.087	1.063	8-32
SAV-26-5M-15 X 1/4	26	1.629	1.584	1.750	6F	.2500	.781	1.087	1.063	8-32
28-5M-15 X 1/4	28	1.754	1.709	1.875	6F	.2500	.781	1.087	1.188	8-32
SAV-28-5M-15 X 1/4	28	1.754	1.709	1.875	6F	.2500	.781	1.087	1.188	8-32
30-5M-15 X 1/4	30	1.880	1.835	2.000	6F	.2500	.781	1.087	1.188	8-32
SAV-30-5M-15 X 1/4	30	1.880	1.835	2.000	6F	.2500	.781	1.087	1.188	8-32

“SAV-” in front of any standard timing pulley part # represents the Shaft-Saver version. Shaft-Saver pulleys have special setscrews that grip without damage to the shaft and allow easy pulley removal and realignment. For additional information, see our Shaft-Saver Engineering Section.



ALUMINUM WITH CLEAR ANODIZE (RoHS compliant)

FOR BELTS UP TO 15MM WIDE

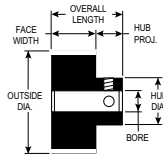

TYPE 6

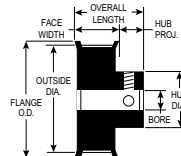

TYPE 6F

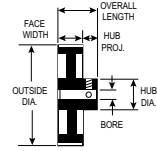

TYPE 6W

PART NUMBER	NO. OF GROOVES	PITCH DIA.	OUTSIDE DIA.	FLANGE O.D.	TYPE	BORE	FACE WIDTH	OVERALL LENGTH	HUB DIA.	SET SCREWS (2@90°)
32-5M-15 X 1/4	32	2.005	1.960	2.125	6F	.2500	.781	1.087	1.250	8-32
SAV-32-5M-15 X 1/4	32	2.005	1.960	2.125	6F	.2500	.781	1.087	1.250	8-32
34-5M-15 X 1/4	34	2.130	2.085	2.250	6F	.2500	.781	1.087	1.375	8-32
SAV-34-5M-15 X 1/4	34	2.130	2.085	2.250	6F	.2500	.781	1.087	1.375	8-32
36-5M-15 X 5/16	36	2.256	2.211	—	6	.3125	.781	1.094	1.500	8-32
SAV-36-5M-15 X 5/16	36	2.256	2.211	—	6	.3125	.781	1.094	1.500	8-32
38-5M-15 X 5/16	38	2.381	2.336	—	6	.3125	.781	1.094	1.500	8-32
SAV-38-5M-15 X 5/16	38	2.381	2.336	—	6	.3125	.781	1.094	1.500	8-32
40-5M-15 X 5/16	40	2.506	2.461	—	6	.3125	.781	1.094	1.500	8-32
SAV-40-5M-15 X 5/16	40	2.506	2.461	—	6	.3125	.781	1.094	1.500	8-32
44-5M-15 X 5/16	44	2.757	2.712	—	6W	.3125	.781	1.094	1.500	8-32
SAV-44-5M-15 X 5/16	44	2.757	2.712	—	6W	.3125	.781	1.094	1.500	8-32
50-5M-15 X 3/8	50	3.133	3.088	—	6W	.3750	.781	1.188	1.500	10-32
SAV-50-5M-15 X 3/8	50	3.133	3.088	—	6W	.3750	.781	1.188	1.500	10-32
56-5M-15 X 3/8	56	3.509	3.464	—	6W	.3750	.781	1.188	1.500	10-32
SAV-56-5M-15 X 3/8	56	3.509	3.464	—	6W	.3750	.781	1.188	1.500	10-32
62-5M-15 X 3/8	62	3.885	3.840	—	6W	.3750	.781	1.188	1.500	10-32
SAV-62-5M-15 X 3/8	62	3.885	3.840	—	6W	.3750	.781	1.188	1.500	10-32
72-5M-15 X 3/8	72	4.511	4.466	—	6W	.3750	.781	1.188	1.500	10-32
SAV-72-5M-15 X 3/8	72	4.511	4.466	—	6W	.3750	.781	1.188	1.500	10-32

“SAV-” in front of any standard timing pulley part # represents the Shaft-Saver version. Shaft-Saver pulleys have special setscrews that grip without damage to the shaft and allow easy pulley removal and realignment. For additional information, see our Shaft-Saver Engineering Section.

ALUMINUM 6061-T6 (RoHS compliant)

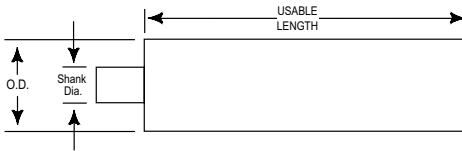

PART NUMBER	NO. OF GROOVES	PITCH DIA.	OUTSIDE DIA.	SHANK DIA.	USEABLE LENGTH
12-5M-P-6A	12	.753	.708	1/2	6"
13-5M-P-6A	13	.815	.770	1/2	6"
14-5M-P-7A	14	.877	.832	1/2	7"
15-5M-P-7A	15	.940	.895	1/2	7"
16-5M-P-7A	16	1.003	.958	1/2	7"
17-5M-P-7A	17	1.065	1.020	1/2	7"
18-5M-P-8A	18	1.128	1.083	1/2	8"
19-5M-P-8A	19	1.191	1.146	1/2	8"
20-5M-P-8A	20	1.253	1.208	1/2	8"
21-5M-P-8A	21	1.316	1.271	1/2	8"
22-5M-P-8A	22	1.379	1.334	1/2	8"
23-5M-P-8A	23	1.441	1.396	1/2	8"
24-5M-P-8A	24	1.504	1.459	1/2	8"
25-5M-P-8A	25	1.566	1.521	1/2	8"
26-5M-P-8A	26	1.629	1.584	1/2	8"
27-5M-P-8A	27	1.692	1.647	1/2	8"
28-5M-P-8A	28	1.754	1.709	1/2	8"
29-5M-P-8A	29	1.817	1.772	1/2	8"
30-5M-P-8A	30	1.880	1.835	1/2	8"
31-5M-P-8A	31	1.942	1.897	3/4	8"
32-5M-P-8A	32	2.005	1.960	3/4	8"

ALUMINUM 6061-T6 (RoHS compliant)

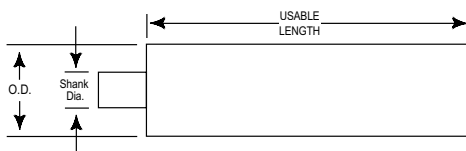
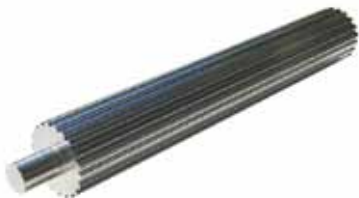

PART NUMBER	NO. OF GROOVES	PITCH DIA.	OUTSIDE DIA.	SHANK DIA.	USEABLE LENGTH
33-5M-P-8A	33	2.068	2.023	3/4	8"
34-5M-P-8A	34	2.130	2.085	3/4	8"
35-5M-P-8A	35	2.193	2.148	3/4	8"
36-5M-P-8A	36	2.256	2.211	3/4	8"
38-5M-P-8A	38	2.381	2.336	3/4	8"
40-5M-P-8A	40	2.506	2.461	3/4	8"
42-5M-P-8A	42	2.632	2.587	3/4	8"
44-5M-P-8A	44	2.757	2.712	3/4	8"
45-5M-P-8A	45	2.820	2.775	3/4	8"
46-5M-P-8A	46	2.882	2.837	3/4	8"
48-5M-P-8A	48	3.008	2.963	3/4	8"
50-5M-P-8A	50	3.133	3.088	3/4	8"
54-5M-P-8A	54	3.384	3.339	3/4	8"
60-5M-P-8A	60	3.760	3.715	3/4	8"
62-5M-P-8A	62	3.885	3.840	3/4	8"
72-5M-P-8A	72	4.511	4.466	1	8"
80-5M-P-8A	80	5.013	4.968	1	8"
90-5M-P-8A	90	5.639	5.594	1	8"
100-5M-P-6A	100	6.266	6.221	1	6"
112-5M-P-6A	112	7.018	6.973	1	6"
126-5M-P-6A	126	7.895	7.850	1	6"

STEEL (RoHS compliant)

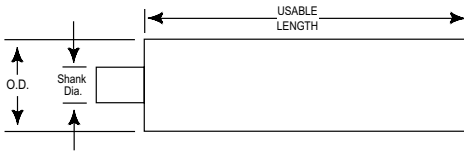

PART NUMBER	NO. OF GROOVES	PITCH DIA.	OUTSIDE DIA.	SHANK DIA.	USEABLE LENGTH
12-5M-P-6S	12	.753	.708	1/2	6"
13-5M-P-6S	13	.815	.770	1/2	6"
14-5M-P-7S	14	.877	.832	1/2	7"
15-5M-P-7S	15	.940	.895	1/2	7"
16-5M-P-7S	16	1.003	.958	1/2	7"
17-5M-P-7S	17	1.065	1.020	1/2	7"
18-5M-P-8S	18	1.128	1.083	1/2	8"
19-5M-P-8S	19	1.191	1.146	1/2	8"
20-5M-P-8S	20	1.253	1.208	1/2	8"
21-5M-P-8S	21	1.316	1.271	1/2	8"
22-5M-P-8S	22	1.379	1.334	1/2	8"
23-5M-P-8S	23	1.441	1.396	1/2	8"
24-5M-P-8S	24	1.504	1.459	1/2	8"
25-5M-P-8S	25	1.566	1.521	1/2	8"
26-5M-P-8S	26	1.629	1.584	1/2	8"
27-5M-P-8S	27	1.692	1.647	1/2	8"
28-5M-P-8S	28	1.754	1.709	1/2	8"
29-5M-P-8S	29	1.817	1.772	1/2	8"
30-5M-P-8S	30	1.880	1.835	1/2	8"

STEEL (RoHS compliant)

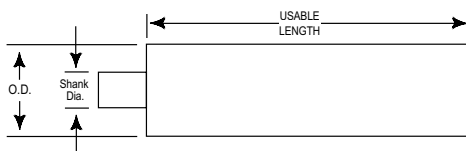
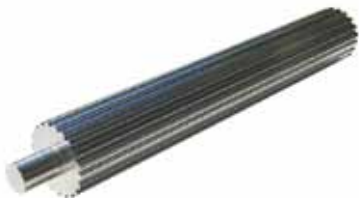

PART NUMBER	NO. OF GROOVES	PITCH DIA.	OUTSIDE DIA.	SHANK DIA.	USEABLE LENGTH
31-5M-P-8S	31	1.942	1.897	3/4	8"
32-5M-P-8S	32	2.005	1.960	3/4	8"
33-5M-P-8S	33	2.068	2.023	3/4	8"
34-5M-P-8S	34	2.130	2.085	3/4	8"
35-5M-P-8S	35	2.193	2.148	3/4	8"
36-5M-P-8S	36	2.256	2.211	3/4	8"
38-5M-P-8S	38	2.381	2.336	3/4	8"
40-5M-P-8S	40	2.506	2.461	3/4	8"
42-5M-P-8S	42	2.632	2.587	3/4	8"
44-5M-P-8S	44	2.757	2.712	3/4	8"
45-5M-P-8S	45	2.820	2.775	3/4	8"
48-5M-P-8S	48	3.008	2.963	3/4	8"
50-5M-P-8S	50	3.133	3.088	3/4	8"
60-5M-P-8S	60	3.760	3.715	3/4	8"
72-5M-P-8S	72	4.511	4.466	1	8"
80-5M-P-8S	80	5.013	4.968	1	8"
90-5M-P-8S	90	5.639	5.594	1	8"

ALUMINUM (RoHS compliant)

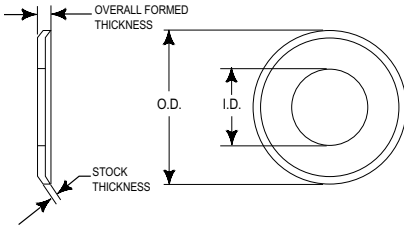

PART NUMBER	INSIDE DIA.	OUTSIDE DIA.	STOCK THICKNESS	OVERALL FORMED THICKNESS
12-5M-F7A	.503	.875	.040	.065
13-5M-F7A	.562	.937	.040	.065
14-5M-F7A	.562	1.000	.040	.065
15-5M-F7A	.625	1.062	.040	.065
16-5M-F7A	.684	1.093	.040	.065
17-5M-F7A	.748	1.187	.040	.065
18-5M-F7A	.810	1.250	.040	.065
19-5M-F7A	.887	1.312	.040	.065
20-5M-F7A	.936	1.375	.040	.065
21-5M-F7A	1.000	1.437	.040	.065
22-5M-F7A	1.062	1.500	.040	.065
23-5M-F7A	1.125	1.562	.040	.065
24-5M-F7A	1.160	1.625	.040	.065
25-5M-F7A	1.223	1.687	.040	.065
26-5M-F7A	1.222	1.750	.040	.065
28-5M-F7A	1.347	1.875	.040	.065
30-5M-F7A	1.425	2.000	.040	.065
32-5M-F7A	1.550	2.125	.040	.065
34-5M-F7A	1.675	2.250	.040	.065

STEEL (RoHS compliant)

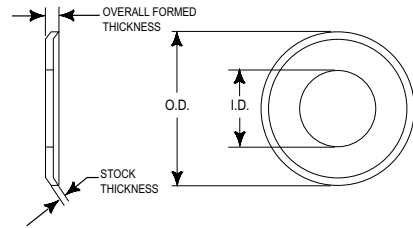

PART NUMBER	INSIDE DIA.	OUTSIDE DIA.	STOCK THICKNESS	OVERALL FORMED THICKNESS
12-5M-F8S	.503	.875	.040	.065
13-5M-F8S	.562	.937	.040	.065
14-5M-F8S	.562	1.000	.040	.065
15-5M-F8S	.625	1.062	.040	.065
16-5M-F8S	.684	1.093	.040	.065
17-5M-F8S	.748	1.187	.040	.065
18-5M-F8S	.810	1.250	.040	.065
19-5M-F8S	.887	1.312	.040	.065
20-5M-F8S	.936	1.375	.040	.065
21-5M-F8S	1.000	1.437	.040	.065
22-5M-F8S	1.062	1.500	.040	.065
23-5M-F8S	1.125	1.562	.040	.065
24-5M-F8S	1.160	1.625	.040	.065
25-5M-F8S	1.223	1.687	.040	.065
26-5M-F8S	1.222	1.750	.040	.065
28-5M-F8S	1.347	1.875	.040	.065
30-5M-F8S	1.425	2.000	.040	.065
32-5M-F8S	1.550	2.125	.040	.065
34-5M-F8S	1.675	2.250	.040	.065

BLACK NEOPRENE, Fiberglass Cord (RoHS compliant)

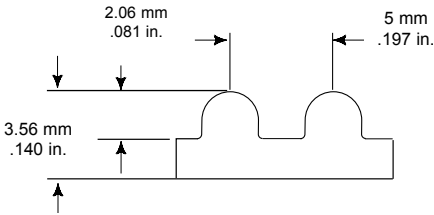

BELT NUMBER	WIDTHS			PITCH LENGTH (MM)	NO. OF TEETH	BELT NUMBER	WIDTHS			PITCH LENGTH (MM)	NO. OF TEETH
	9MM	15MM	25MM				9MM	15MM	25MM		
180-5M	09	15	25	180	36	450-5M	09	15	25	450	90
200-5M	09	15	25	200	40	460-5M	09	15	25	460	92
225-5M	09	15	25	225	45	475-5M	09	15	25	475	95
240-5M	09	15	25	240	48	480-5M	09	15	25	480	96
255-5M	09	15	25	255	51	495-5M	09	15	25	495	99
260-5M	09	15	25	260	52	500-5M	09	15	25	500	100
265-5M	09	15	25	265	53	520-5M	09	15	25	520	104
270-5M	09	15	25	270	54	525-5M	09	15	25	525	105
275-5M	09	15	25	275	55	535-5M	09	15	25	535	107
280-5M	09	15	25	280	56	550-5M	09	15	25	550	110
285-5M	09	15	25	285	57	555-5M	09	15	25	555	111
295-5M	09	15	25	295	59	560-5M	09	15	25	560	112
300-5M	09	15	25	300	60	565-5M	09	15	25	565	113
305-5M	09	15	25	305	61	575-5M	09	15	25	575	115
310-5M	09	15	25	310	62	580-5M	09	15	25	580	116
320-5M	09	15	25	320	64	585-5M	09	15	25	585	117
325-5M	09	15	25	325	65	590-5M	09	15	25	590	118
330-5M	09	15	25	330	66	600-5M	09	15	25	600	120
335-5M	09	15	25	335	67	610-5M	09	15	25	610	122
340-5M	09	15	25	340	68	615-5M	09	15	25	615	123
345-5M	09	15	25	345	69	635-5M	09	15	25	635	127
350-5M	09	15	25	350	70	640-5M	09	15	25	640	128
360-5M	09	15	25	360	72	645-5M	09	15	25	645	129
365-5M	09	15	25	365	73	655-5M	09	15	25	655	131
370-5M	09	15	25	370	74	665-5M	09	15	25	665	133
375-5M	09	15	25	375	75	670-5M	09	15	25	670	134
385-5M	09	15	25	385	77	680-5M	09	15	25	680	136
400-5M	09	15	25	400	80	685-5M	09	15	25	685	137
405-5M	09	15	25	405	81	695-5M	09	15	25	695	139
415-5M	09	15	25	415	83	700-5M	09	15	25	700	140
425-5M	09	15	25	425	85	710-5M	09	15	25	710	142

Need a clean, low dust belt? See TruMotion belts.

York also manufactures custom pulleys and complete assemblies
 email: support@york-ind.com web: www.york-ind.com



BLACK NEOPRENE, Fiberglass Cord (RoHS compliant)

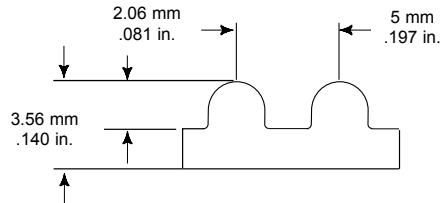

BELT NUMBER	WIDTHS			PITCH LENGTH (MM)	NO. OF TEETH	BELT NUMBER	WIDTHS			PITCH LENGTH (MM)	NO. OF TEETH
	9MM	15MM	25MM				9MM	15MM	25MM		
740-5M	09	15	25	740	148	1135-5M	09	15	25	1135	227
745-5M	09	15	25	745	149	1175-5M	09	15	25	1175	235
750-5M	09	15	25	750	150	1195-5M	09	15	25	1195	239
755-5M	09	15	25	755	151	1200-5M	09	15	25	1200	240
765-5M	09	15	25	765	153	1225-5M	09	15	25	1225	245
770-5M	09	15	25	770	154	1250-5M	09	15	25	1250	250
775-5M	09	15	25	775	155	1270-5M	09	15	25	1270	254
790-5M	09	15	25	790	158	1295-5M	09	15	25	1295	259
800-5M	09	15	25	800	160	1350-5M	09	15	25	1350	270
825-5M	09	15	25	825	165	1375-5M	09	15	25	1375	275
830-5M	09	15	25	830	166	1420-5M	09	15	25	1420	284
835-5M	09	15	25	835	167	1575-5M	09	15	25	1575	315
850-5M	09	15	25	850	170	1595-5M	09	15	25	1595	319
860-5M	09	15	25	860	172	1635-5M	09	15	25	1635	327
870-5M	09	15	25	870	174	1690-5M	09	15	25	1690	338
890-5M	09	15	25	890	178	1720-5M	09	15	25	1720	344
900-5M	09	15	25	900	180	1790-5M	09	15	25	1790	358
925-5M	09	15	25	925	185	1800-5M	09	15	25	1800	360
935-5M	09	15	25	935	187	1870-5M	09	15	25	1870	374
940-5M	09	15	25	940	188	1895-5M	09	15	25	1895	379
950-5M	09	15	25	950	190	1945-5M	09	15	25	1945	389
965-5M	09	15	25	965	193	1980-5M	09	15	25	1980	396
975-5M	09	15	25	975	195	2000-5M	09	15	25	2000	400
980-5M	09	15	25	980	196	2100-5M	09	15	25	2100	420
985-5M	09	15	25	985	197	2110-5M	09	15	25	2110	422
1000-5M	09	15	25	1000	200	2250-5M	09	15	25	2250	450
1025-5M	09	15	25	1025	205	2350-5M	09	15	25	2350	470
1035-5M	09	15	25	1035	207	2525-5M	09	15	25	2525	505
1050-5M	09	15	25	1050	210	2760-5M	09	15	25	2760	552
1100-5M	09	15	25	1100	220	3120-5M	09	15	25	3120	624
1125-5M	09	15	25	1125	225	3800-5M	09	15	25	3800	760

If you don't see the belt you need – call York!

YORK

ISO 9001: 2008 Registered

303 Nassau Blvd., Garden City Park, NY 11040

Tel: 1-800 354 8466 Fax: 1-800 354 8485

Cream Colored Engineered Polymer with Fiberglass Cord (RoHS compliant)

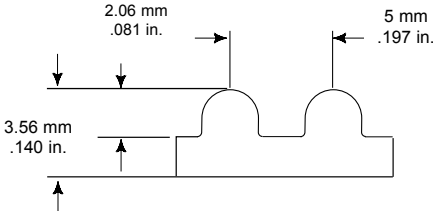

BELT NUMBER	WIDTHS			PITCH LENGTH (MM)	NO. OF TEETH	BELT NUMBER	WIDTHS			PITCH LENGTH (MM)	NO. OF TEETH
	9MM	15MM	25MM				9MM	15MM	25MM		
TM-180-5M	09	15	25	180	36	TM-450-5M	09	15	25	450	90
TM-200-5M	09	15	25	200	40	TM-460-5M	09	15	25	460	92
TM-225-5M	09	15	25	225	45	TM-475-5M	09	15	25	475	95
TM-240-5M	09	15	25	240	48	TM-480-5M	09	15	25	480	96
TM-255-5M	09	15	25	255	51	TM-495-5M	09	15	25	495	99
TM-260-5M	09	15	25	260	52	TM-500-5M	09	15	25	500	100
TM-265-5M	09	15	25	265	53	TM-520-5M	09	15	25	520	104
TM-270-5M	09	15	25	270	54	TM-525-5M	09	15	25	525	105
TM-275-5M	09	15	25	275	55	TM-535-5M	09	15	25	535	107
TM-280-5M	09	15	25	280	56	TM-550-5M	09	15	25	550	110
TM-285-5M	09	15	25	285	57	TM-555-5M	09	15	25	555	111
TM-295-5M	09	15	25	295	59	TM-560-5M	09	15	25	560	112
TM-300-5M	09	15	25	300	60	TM-565-5M	09	15	25	565	113
TM-305-5M	09	15	25	305	61	TM-575-5M	09	15	25	575	115
TM-310-5M	09	15	25	310	62	TM-580-5M	09	15	25	580	116
TM-320-5M	09	15	25	320	64	TM-585-5M	09	15	25	585	117
TM-325-5M	09	15	25	325	65	TM-590-5M	09	15	25	590	118
TM-330-5M	09	15	25	330	66	TM-600-5M	09	15	25	600	120
TM-335-5M	09	15	25	335	67	TM-610-5M	09	15	25	610	122
TM-340-5M	09	15	25	340	68	TM-615-5M	09	15	25	615	123
TM-345-5M	09	15	25	345	69	TM-635-5M	09	15	25	635	127
TM-350-5M	09	15	25	350	70	TM-640-5M	09	15	25	640	128
TM-360-5M	09	15	25	360	72	TM-645-5M	09	15	25	645	129
TM-365-5M	09	15	25	365	73	TM-655-5M	09	15	25	655	131
TM-370-5M	09	15	25	370	74	TM-665-5M	09	15	25	665	133
TM-375-5M	09	15	25	375	75	TM-670-5M	09	15	25	670	134
TM-385-5M	09	15	25	385	77	TM-680-5M	09	15	25	680	136
TM-400-5M	09	15	25	400	80	TM-685-5M	09	15	25	685	137
TM-405-5M	09	15	25	405	81	TM-695-5M	09	15	25	695	139
TM-415-5M	09	15	25	415	83	TM-700-5M	09	15	25	700	140
TM-425-5M	09	15	25	425	85	TM-710-5M	09	15	25	710	142

If you don't see the belt you need – call York!

York also manufactures custom pulleys and complete assemblies
 email: support@york-ind.com web: www.york-ind.com



Cream Colored Engineered Polymer with Fiberglass Cord (RoHS compliant)

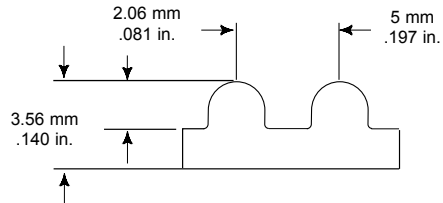

BELT NUMBER	WIDTHS			PITCH LENGTH (MM)	NO. OF TEETH	BELT NUMBER	WIDTHS			PITCH LENGTH (MM)	NO. OF TEETH
	9MM	15MM	25MM				9MM	15MM	25MM		
TM-740-5M	09	15	25	740	148	TM-1135-5M	09	15	25	1135	227
TM-745-5M	09	15	25	745	149	TM-1175-5M	09	15	25	1175	235
TM-750-5M	09	15	25	750	150	TM-1195-5M	09	15	25	1195	239
TM-755-5M	09	15	25	755	151	TM-1200-5M	09	15	25	1200	240
TM-765-5M	09	15	25	765	153	TM-1225-5M	09	15	25	1225	245
TM-770-5M	09	15	25	770	154	TM-1250-5M	09	15	25	1250	250
TM-775-5M	09	15	25	775	155	TM-1270-5M	09	15	25	1270	254
TM-790-5M	09	15	25	790	158	TM-1295-5M	09	15	25	1295	259
TM-800-5M	09	15	25	800	160	TM-1350-5M	09	15	25	1350	270
TM-825-5M	09	15	25	825	165	TM-1375-5M	09	15	25	1375	275
TM-830-5M	09	15	25	830	166	TM-1420-5M	09	15	25	1420	284
TM-835-5M	09	15	25	835	167	TM-1575-5M	09	15	25	1575	315
TM-850-5M	09	15	25	850	170	TM-1595-5M	09	15	25	1595	319
TM-860-5M	09	15	25	860	172	TM-1635-5M	09	15	25	1635	327
TM-870-5M	09	15	25	870	174	TM-1690-5M	09	15	25	1690	338
TM-890-5M	09	15	25	890	178	TM-1720-5M	09	15	25	1720	344
TM-900-5M	09	15	25	900	180	TM-1790-5M	09	15	25	1790	358
TM-925-5M	09	15	25	925	185	TM-1800-5M	09	15	25	1800	360
TM-935-5M	09	15	25	935	187	TM-1870-5M	09	15	25	1870	374
TM-940-5M	09	15	25	940	188	TM-1895-5M	09	15	25	1895	379
TM-950-5M	09	15	25	950	190	TM-1945-5M	09	15	25	1945	389
TM-965-5M	09	15	25	965	193	TM-1980-5M	09	15	25	1980	396
TM-975-5M	09	15	25	975	195	TM-2000-5M	09	15	25	2000	400
TM-980-5M	09	15	25	980	196	TM-2100-5M	09	15	25	2100	420
TM-985-5M	09	15	25	985	197	TM-2110-5M	09	15	25	2110	422
TM-1000-5M	09	15	25	1000	200	TM-2250-5M	09	15	25	2250	450
TM-1025-5M	09	15	25	1025	205	TM-2350-5M	09	15	25	2350	470
TM-1035-5M	09	15	25	1035	207	TM-2525-5M	09	15	25	2525	505
TM-1050-5M	09	15	25	1050	210	TM-2760-5M	09	15	25	2760	552
TM-1100-5M	09	15	25	1100	220	TM-3120-5M	09	15	25	3120	624
TM-1125-5M	09	15	25	1125	225	TM-3800-5M	09	15	25	3800	760

If you don't see the belt you need – call York!

YORK

ISO 9001: 2008 Registered

303 Nassau Blvd., Garden City Park, NY 11040

Tel: 1-800 354 8466 Fax: 1-800 354 8485